



MODEL
MSK-A

For household use

Stainless Steel Bottle

Instructions

Thank you for purchasing a "TIGER" Stainless Steel Bottle.
Please read the instructions completely before use.
Keep these instructions for future reference.

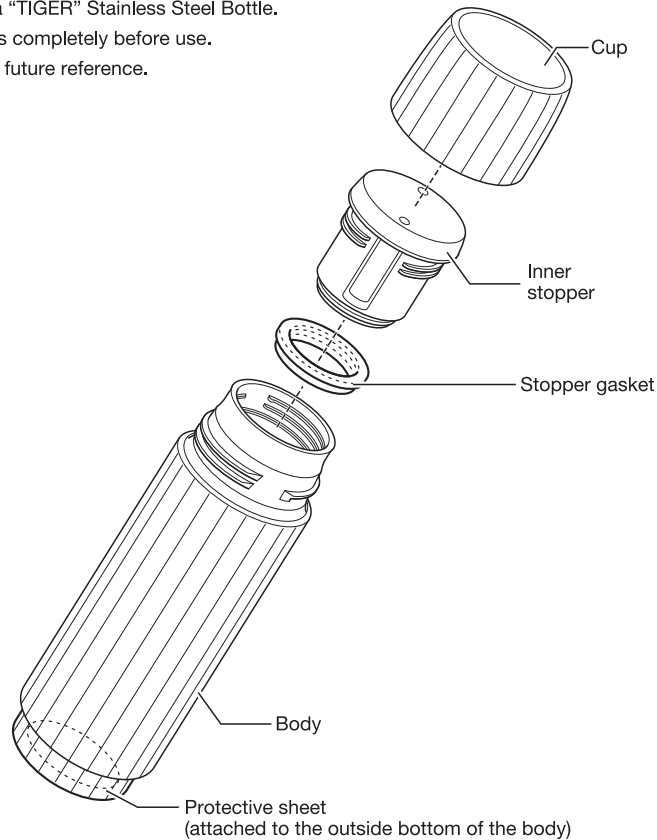

Make sure that all parts are present before use.

Safety Precautions

- ◆ All safety instructions described below are intended to protect the user and other individuals from physical harm and household damage.
- ◆ Safety instructions are classified and described according to the level of harm and damage caused by improper use, as shown below.



This symbol indicates there is a possibility of death or serious injury.



This symbol indicates there is a possibility of injury or damage to property.

Description of Symbols



This symbol indicates a prohibited action.



This symbol indicates an action that must be taken or an instruction that must be followed.

Warning



Keep out of reach of children. Do not let children play with the product.

There is a risk of burns or injuries.

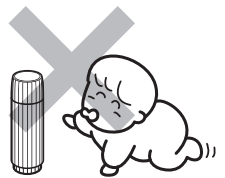

Caution



Do not put dry ice or carbonated beverages in the product.

The air pressure inside the product may increase, causing the stopper to become stuck or prone to shattering, or the parts to be damaged.



Do not place the product near stoves, open flames, or other sources of extreme heat.

There is a risk of burns or deformation or discoloring of the product.



Do not store milk, dairy products, or certain fruit juices in the product.

The contents may decay or spoil. Long-time spoilage can create gases that raise the air pressure inside the product due to decay or spoil, causing the stopper to become stuck or prone to shattering, or the parts to be damaged.



Do not heat the product in a microwave oven.

There is a risk of injury or failure due to sparks.



Do not touch the brim of the product with a kettle spout.

The product may fall over, causing burns or injuries to the skin, or a scratch or deformation to the product.



Be sure to follow all instructions.

Caution

-  **Be sure to set the stopper in proper position.**
Otherwise, the contents may leak, causing burns and contamination.

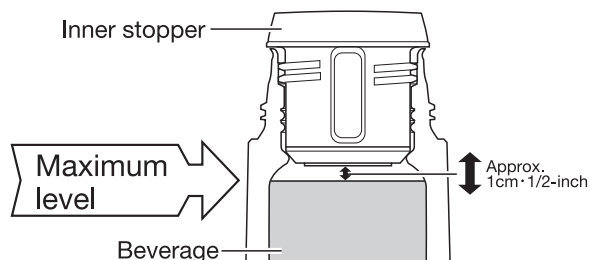
-  **Do not fill the product above the maximum level shown below.**



-  **Do not use the product if its ability to retain heat declines.**
Hot beverages can make the product very hot, potentially causing burns.
-  **Do not use the product for any purpose other than keeping beverages warm or cold for drinking.**
-  **Do not knock over, drop or expose the product to excessive shocks.**
There is a risk of damage to the product, a reduction of its heat- or cold-retention ability, rusting, or leakage of contents.

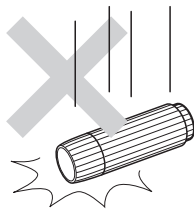



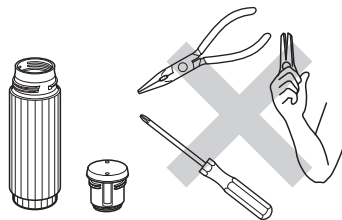





-  **Do not disassemble or attempt to repair the product by yourself.**
There is a risk of failure or accident.
※The body or inner stopper can not be disassembled.





Do not remove the sticker on the bottom of the product.

Caution

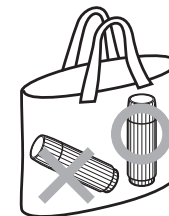
-  **Do not put the product in a freezer.**
Contents may leak or the product may be damaged.
-  **Do not store tea leaves or peeled fruit.**
The contents may leak.
-  **Be sure to clean the product immediately after use, especially after consuming sports drinks.**
Rinse the inside of the product well, even if you are going out, for example, and don't have time to wash it thoroughly. Mold, rust, or holes may appear.
-  **Do not store soups or beverages containing salt in the product.**
The product may become decayed, spoiled, or rusted.
-  **Do not leave the product in a bag for a long time.**
The storage conditions may change and there is a risk of rust or odors.
-  **Do not use chlorine-based bleaches.**
This may cause rusting, a hole on the product.
-  **Do not remove the sticker on the bottom of the product.**
Removing this may damage the product.
-  **Keep the product in an upright position at all times in your bag to avoid leakage.**
Contents may leak if the product is laid horizontally.



-  **Do not use the product in a moving vehicle.**
This may result in burns or soiling of clothes or of the interior of the vehicle. (Using the product while you are driving is very dangerous, as you may be distracted.)
-  **Keep the product in an upright position at all times.**

! Caution

- ! **Use the cup to drink.**
Drinking directly from the body may result in spillage or burns. (Hot drink inside the body does not make the outside hot because of the insulation effect.)
- ⊘ **Do not tilt the product abruptly when pouring the beverage into the cup.**
- ⊘ **When pouring into the cup, do not turn the inner stopper too much. Doing so may cause the inner stopper to get out of the body and the hot drink inside to come out suddnly, which results in burns.**
- ! **After poring, be sure to set the body in an upright position, tighten the inner stopper until it does not turn any more and close it with the cap.**
- ⊘ **Consume beverage within the day to prevent from spoiling.**
If the beverage is left for an extended period, spoilage can lead to the creation of gas, raising the pressure inside the product.
This can cause the contents to burst out or damage the stopper, possibly resulting in injury.
- ! **Ice changes the inner pressure so the gasket may dislocate.**
If this happens, set it back into it's proper position.

For can holder

- ! **Before using the can holder, check its intensity.**
If the holder is not strong enough, it may come off and get damaged. This may result in burns or soiling of clothes or of the interior of the vehicle.
- ! **When using a commercially available can holder, use the stationary type.**
If the suspension holder that is attached to the window or air conditioning outlet is used, it may come off. This may result in burns or soiling of clothes or of the interior of the vehicle.

How to Use



When Using for the First Time

● Cleaning

You may notice an unusual odor coming from the material of the product. In this case, clean the product by following the steps below.

- ① Pour hot water into the main body and securely close the stopper.
 - Check that the stopper gasket is attached to the stopper.
- ② Hold the main body and gently shake it several times to rinse the inside thoroughly (Do not shake it excessively. The hot water may splash out , potentially causing burns.)
- ③ Discard the hot water, and then clean each part.

1

Turn the stopper to remove it.

- Check that the stopper gasket is attached to the stopper.

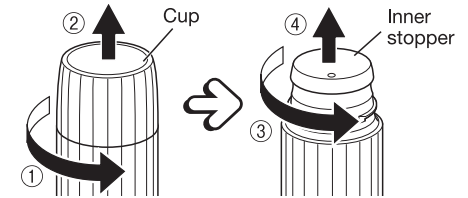

2

To keep your beverage warm/cool longer, first pour a small amount of hot/cold water into the main body and let it sit for one or two minutes.

- Discard the hot/cold water after preheating/precooling.

3

Pour your hot/cold beverage into the main body.

- Do not fill the product above the maximum level shown below.
- Do not insert large cubes of ice. Use small cubes or crushed ice.
- When hot tea is inside, the color of tea may change. Because it is possible for the inner stopper to be clogged, please use tea bags, etc.

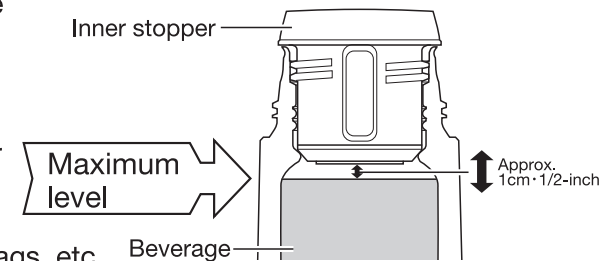

- Be sure to wipe off drinks spilled outside the body.

4

Place the main body in an upright position and turn the stopper and cup to close it.

- Turn the stopper and cup as far as it will go to securely close it.

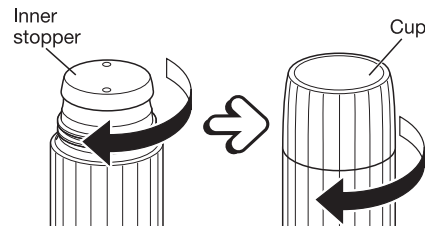

5

Hold the main body and open the cup and stopper to drink your beverage.

- With the body set in the upright position, the inner stopper gently sticks before it makes a half turn by turning it slowly.
※ Turning the inner stopper too much may cause the inner stopper to get out of the body.
- Hold the main body, tilt in the direction of the ○ mark on the surface of the inner stopper and then pour the drink.
※ Please do not tilt in directions other than ○. Doing so may cause the Drinks to scatter, which may result in injury and burns.

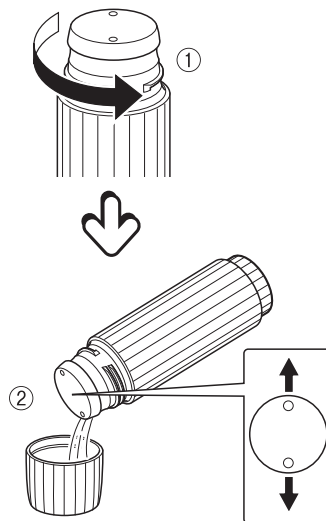

Caution

- Do not shake the whole product.
- Do not tilt the product abruptly when pouring the beverage into the cup.

How to Use

6

After drinking the beverage, keep the product in an upright position and securely close the stopper and cup.

- Shake off the "water drop" remaining inside the cup, wipe it well and close it.

Caution

- If you place the product in a bag, make sure it is upright to prevent any accidental leakage. The product may leak if you place it on its side.



- ① Keep the product in an upright position.

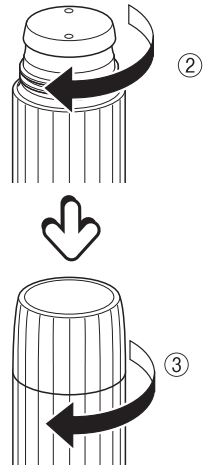

The product rattles when shaken.

This is caused by a metal sheet moving inside the product that is used for boosting heat retention.

How to Clean

- ◆ Clean the product on the same day after every use.
- ◆ Use mild kitchen detergent (for table or cookware).
- ◆ Use a soft sponge or cloth.
- ◆ Clean the product thoroughly to prevent any odor.

- ① Wash each part using a sponge with diluted detergent water or lukewarm water, and then thoroughly rinse it with water.
- ② Wipe the water off with a dry cloth and dry the parts thoroughly.
 - ※ The body or inner stopper can not be disassembled.

Caution

- Do not soak the main body and stopper when washing them. (Water may enter the main body and stopper.)
- Do not use thinners, cleansers, bleaches, cleaning wipes, metallic scrubbing brushes, or nylon scrubbing brushes.
- Do not use a dishwasher or dish dryer, and do not wash with boiling water.
- Be sure to attach the stopper and stopper gasket.
- When the product is not to be used for a long period of time, thoroughly wash off any marks and then dry it.

Attaching and removing the gasket

Attach the gasket fully and securely.

Caution

- When attaching the gasket, check its position and direction. Contents may leak.

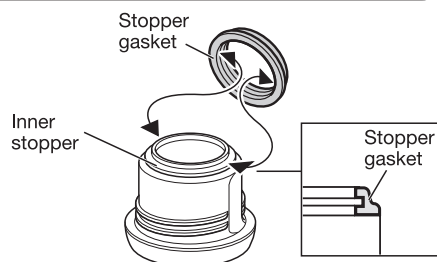

Countermeasure against staining inside the main body

For red, rust-like spots or rough areas

- Such staining can be caused by minerals in water, such as calcium, magnesium, and iron. It is recommended to clean with citric acid, which is available at supermarkets and drugstores.
- (1) Dilute the citric acid (approximately 10 g) in lukewarm water, and then pour it into the main body.
 - (2) After a few hours have elapsed, wash the main body with a soft brush and then thoroughly rinse it.
 - (3) Dry the main body completely.

MSK-A

Replacing and Purchasing Consumable Parts

The gasket and lid are consumable parts. Check once a year for damage/deterioration. If heavily stained or loose, replace them. For replacement parts, contact customer service or the shop where you purchased this product.

Before Contacting Customer Service

The utmost measures have been taken to ensure the quality of this product. Should the product be defective, however, contact your dealer and provide the following information.

1. Product name
2. Model Number
3. Description of trouble (As detailed as possible)
4. Purchase date

Feel free to send any questions or comments about this product to the shop where you purchased it.

※ For the purpose of performance improvement, designs, specifications and parts shown in this publication are subject to change without notice.

Specifications

Model No.	MSK-A030
Capacity	0.30L / 10.1 oz
Heat retention	Greater than 85°C • 185°F (1 hour) Greater than 66°C • 150°F (6 hours)
Cold retention	Less than 9°C • 49°F (6 hours)
Size*	W 7.1 x D 7.1 x H 20.8 cm W 2.80 x D 2.80 x H 8.19 in
Weight*	0.24kg / 0.53 lbs

* Approximate value

※ Heat retention has been calculated under the condition of adding hot water at 95°C ±1°C • 203°F±2°F and leaving it in a room temperature of 20°C±2°C • 68°F±4°F for 1 hour or 6 hours.

※ Cold retention has been calculated under the condition of adding cold water at 4°C ±1°C • 39°F±2°F and leaving it in a room temperature of 20°C±2°C • 68°F±4°F for 6 hours.

※ Capacity is the actual volume of water that can be stored into the product when the spout is closed. This is not the "Maximum level" volume described in "Safety Precautions".



TIGER CORPORATION

Head Office: 3-1 Hayami-cho, Kadoma City, Osaka 571-8571, Japan

TIGER CORPORATION HONG KONG LIMITED

Rm. 1006B, 10/FI., Join-in Hang Sing Centre, 71 - 75 Container Port Road, Kwai Chung, N.T.

Tel: (852) 2418-0912 Fax: (852) 2418-0911

URL : <http://tiger-corporation.hk/>

TIGER CORPORATION U.S.A.

1815 W 205th Street, Unit 106, Torrance, CA 90501

Tel: 1-866-55-TIGER (84437)

Email: support@japantigercorp.com

URL : <https://tiger-corporation-us.com/>