

How to Clean

- ◆ Clean after every use.
- ◆ Use mild kitchen detergent.
- ◆ Use a sponge or soft cloth.
- ◆ Clean the product thoroughly to prevent odors.

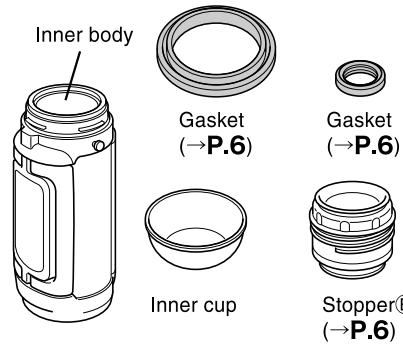

1. Wash it with soft sponge and diluted dish soap or warm water. Rinse well with running water.
2. Ensure all moisture is wiped from the product after cleaning.

To deodorize

For first time usage, adding sugary drink and tea; rinse inner container trough with hot water for each usage to prevent from odor.

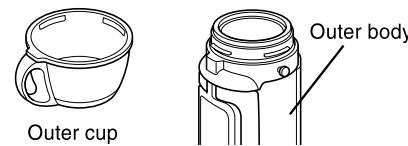

1. Mix diluted dish soap and hot water. Soak wash cloth into the cleaning solution and then squeeze the wash cloth. Wipe off cup and outer surface of main body.
2. Wipe off cleaning solution with dry cloth and then air dry.

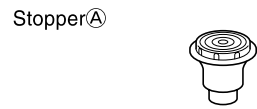

1. Mix diluted dish soap and hot water. Soak wash cloth into the cleaning solution and then squeeze the wash cloth. Wipe off cup and outer surface of main body.
2. Wipe off cleaning solution with dry cloth and then air dry.

Caution

- Do not immerse main body and outer cup into water.
- Do not use pait thinner, heavy duty cleanser, bleach, duster wipe, metal brush and nylon brush.
- Do not use dish washer, dryer and scalded.

- Be sure the gaskets are set it properly.
- If you do not use the product for a long time, clean the bottle, cup, stopper and gaskets. Wipe them all with a dry cloth, and allow them to air dry. Then store the product.

5

Stopper

Turn anticlockwise to undo the stopper (A) from (B).

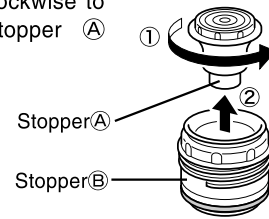

Turn clockwise to attach the stopper (A) to (B).



Gasket

Ensure the gasket is attached properly.

Caution

Be sure the gasket is properly set it.

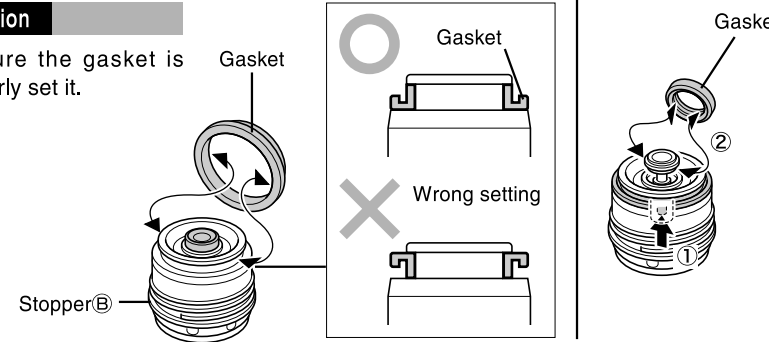

[Reddish rust like spot] or [Rough surface] appear on the product, clean it with Citric Acid.

Decalcifying the unit.

1. Add 10g of Citric Acid and mix with warm water. And then leave Citric Acid solution for 2-3 hours.
2. Wash with soft brush, then rinse out thoroughly with running water.
3. Ensure all moisture is wiped from the product after cleaning.

- * Contact customer service.
- * Do not use ordinary water heater/bottle cleaner. Ordinary cleaner may contain chlorine bleach and it may damage the gaskets.

6

Replacing and Purchasing Consumable Parts

The gasket and cap are consumable parts. Check once a year for damage/deterioration. If heavily stained or loose, replace them. For replacement parts, contact customer service or the shop where you purchased this product.

Before contact customer service

The utmost measures have been taken to ensure the quality of this product. Should the product be defective, however, contact your dealer and provide the following information.

1. Product name
 2. Model Number
 3. Description of trouble (As detailed as possible)
- Feel free to send any questions or comments about this product to the shop where you purchased it.

*For the purpose of performance improvement, designs, specifications and parts shown in this publication are subject to change without notice.

Specifications

Capacity	Heat retention	Cold retention
1.2 liters/40.5 oz	Greater than 55°C • 131°F (24hours)	Less than 8°C • 46°F (6hours)
	Greater than 78°C • 172°F (6hours)	
1.49 liters/50.3 oz	Greater than 57°C • 135°F (24hours)	Less than 8°C • 46°F (6hours)
	Greater than 80°C • 176°F (6hours)	
1.65 liters/55.7 oz	Greater than 58°C • 136°F (24hours)	Less than 7°C • 45°F (6hours)
	Greater than 80°C • 176°F (6hours)	
2.0 liters/67.6 oz	Greater than 62°C • 144°F (24hours)	Less than 7°C • 45°F (6hours)
	Greater than 81°C • 178°F (6hours)	

* Heat retention has been calculated under the condition of adding hot water at 95°C ± 1°C • 203°F ± 2°F and leaving it in a room temperature of 20°C ± 2°C • 68°F ± 4°F for 24hours or 6hours.

* Cold retention has been calculated under the condition of adding cold water at 4°C ± 1°C • 39°F ± 2°F and leaving it in a room temperature of 20°C ± 2°C • 68°F ± 4°F for 6hours.

* Capacity is actual volume that water can be stored into the product when the stopper is closed.



TIGER CORPORATION

Head Office: 3-1 Hayamicho, Kadoma-City, Osaka, 571-8571 Japan
URL: <http://www.tiger.jp/global.html>



MODEL
MHK-A

Stainless Steel Bottle

Instructions

Thank you for purchasing a "TIGER" Stainless Steel Bottle. Please read the instructions completely before use. Keep these instructions for future reference.

Features(Name of Parts)

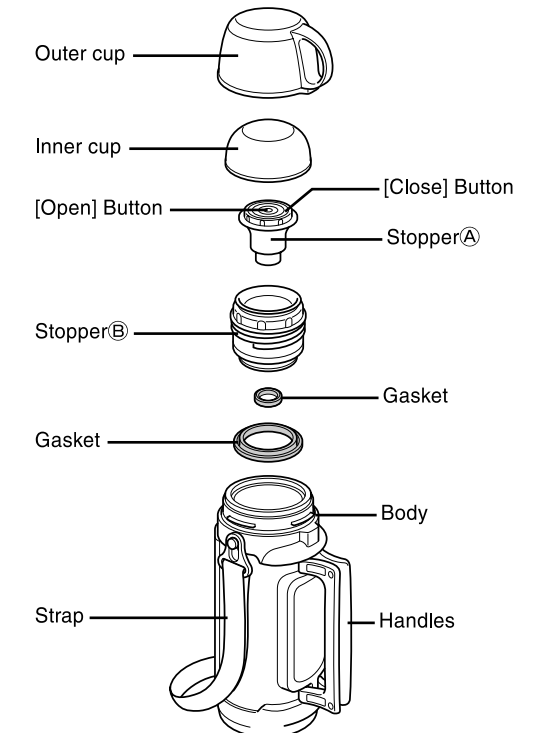

Safety Precautions

Keep out of reach of children.

Be sure to close the stopper and push [Close] Button down.

Do not fill the bottle above the maximum level shown below.

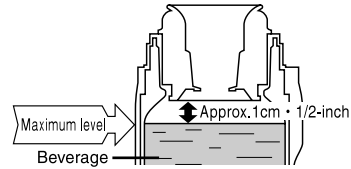

Do not put dry ice or carbonated beverages in the bottle.

Do not place the bottle near stoves, open flames, or other sources of extreme heat.

Do not use the bottle for any purposes other than keeping beverages warm or cold.

Do not disassemble or attempt to repair the bottle by yourself.

Be sure to clean the product immediately specially after sports drink.

For Best Results

The following may cause the quality of the product to deteriorate.

- Storing milk, dairy products, or certain fruit juices in the bottle.
- Storing soups or beverages containing salt in the bottle.
- Using chlorine-based bleaches when cleaning the bottle.

The following may cause spills, diminish the bottle's ability to maintain beverage temperatures, or otherwise damage the product.

- Knocking over, dropping, or exposing the bottle to excessive shocks.
- Placing the bottle on its side.

1

How to use

1 Remove the stopper and cups.

Before first use

Be sure to clean it prior use. → P.5

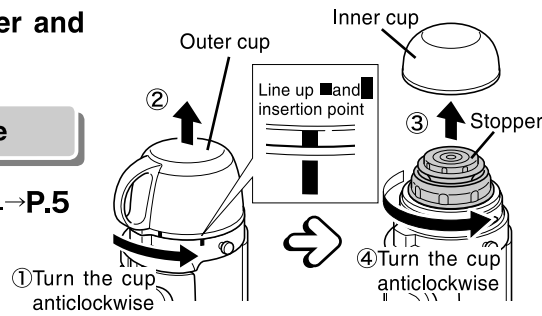

2 To keep your beverage warm or cool longer. Pour hot (or cold) water into the bottle, and let it sit for one or two minutes to allow the inside of the bottle to heat (or cool).

Preheat with hot water. Precool with cold water.

3 Pour desired drink

- Do not fill the bottle above the maximum level shown right.
- Do not push into big ice cube. Use small or crushed ice.
- Hot tea may change color of tea. Loose tea may clog the stopper. Use tea bag.

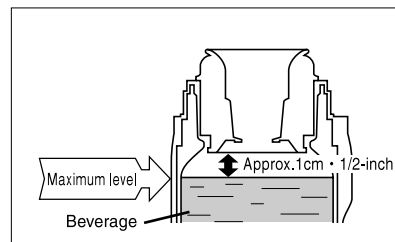

Caution

Wipe off outer body

2

4 Close stopper and cup

- Be sure to close securely.
- Be sure to [Close] Button is down. → P.4

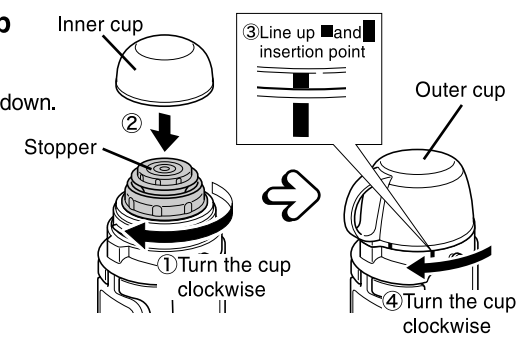

5 Remove the cup, push [Open] Button down, tilt the main body to pour drink.

Caution

Do not push [Open] Button when it tilted. Drink may gush out.

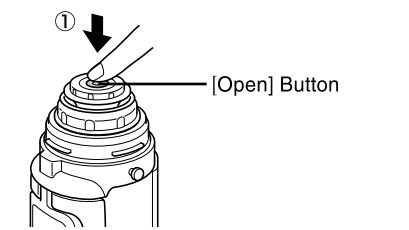

How to use handles

Lift handles up from side.

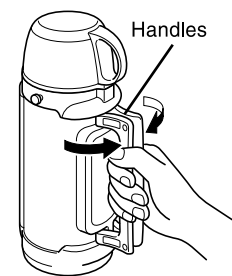

3

6 Be sure pause 2-3 second in upright position, then push [Close] Button down.

Caution

Do not push [Close] Button when it tilted. Moisture stayed in the stopper and it may leak.

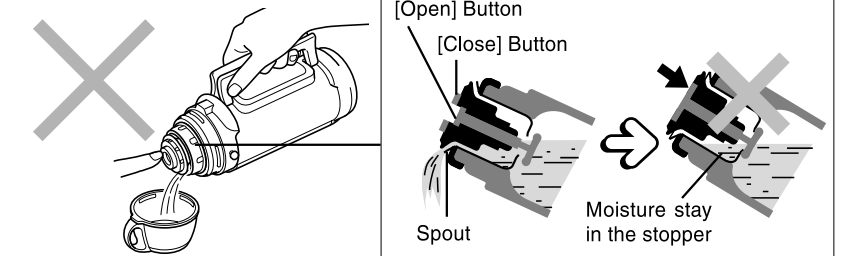
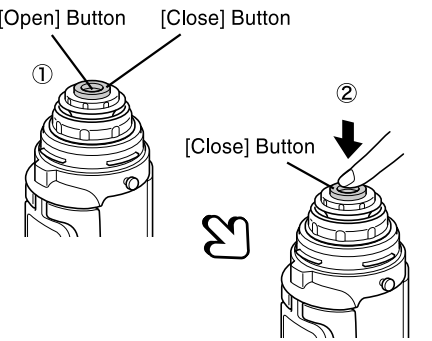

7 Close the cup → P.3

Wipe off inner cup before set it back.

How to attach strap

1. Align hole with peg.

2. Pull down until it snap into place.

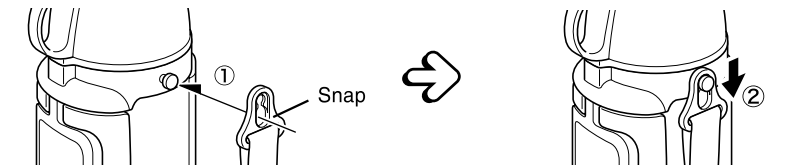

* To remove, follow the instruction above in reverse order.

4